

IDENTIFICATION STAMP
DIVISION OF STATE
ARCHITECT
OFFICE OF REGULATION
SERVICES
FILE NO.
APPL. NO.

AC FLS SS
DATE



SARAH K. CURRAN R.C.E. 69620

LOS ANGELES UNIFIED SCHOOL DISTRICT
**CRENSHAW H.S. PERFORMING ARTS
CENTER AND FOOD SERVICE
FACILITY**
9001 11TH AVE. LOS ANGELES, CA 90003

PREPARED FOR THE
**Los Angeles Unified School District
Facilities Services Division**
330 S. BEVERLY BLVD. 2ND FLOOR
LOS ANGELES, CA 90011
213-241-4011



osborn

NAC NO 161-14020
DATE 04-24-2015
DRAWN DL
CHECKED SC

C1.0

**SITE DEMOLITION
PLAN**

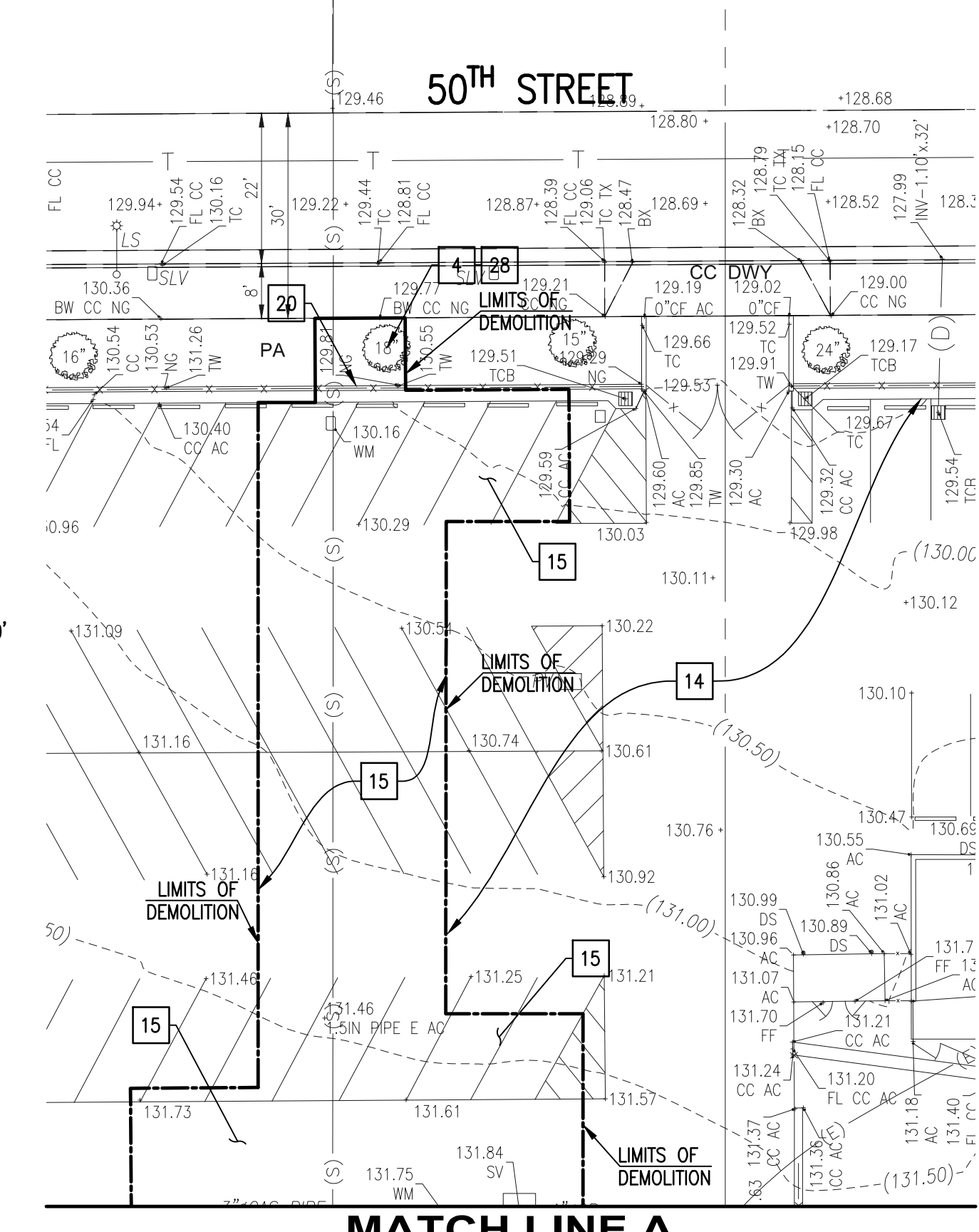
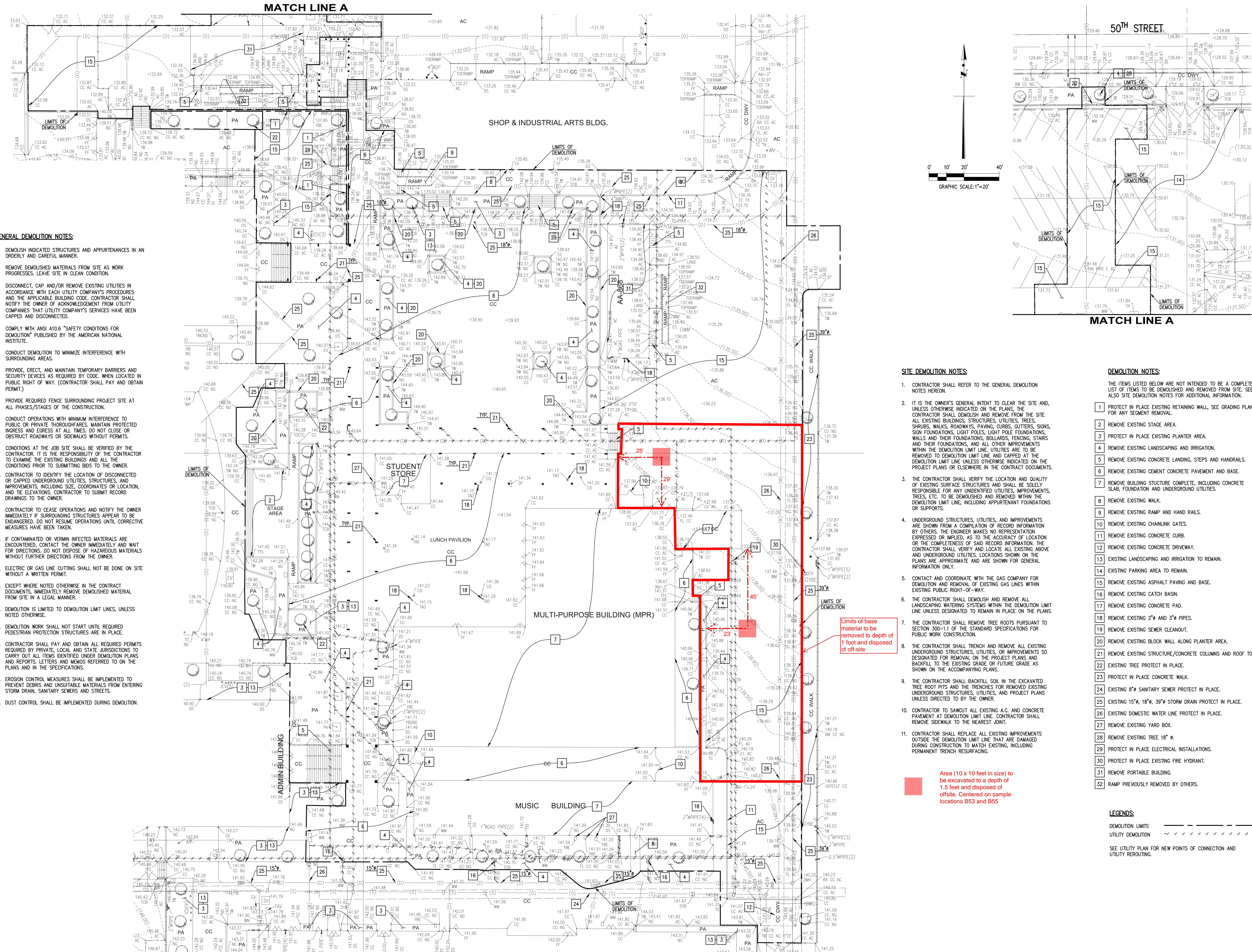

GENERAL DEMOLITION NOTES:

- DEMOLISH INDICATED STRUCTURES AND APPURTENANCES IN AN ORDERLY AND CAREFUL MANNER.
- REMOVE DEMOLISHED MATERIALS FROM SITE AS WORK PROGRESSES. LEAVE SITE IN CLEAN CONDITION.
- DISCONNECT, CAP AND/OR REMOVE EXISTING UTILITIES IN ACCORDANCE WITH EACH UTILITY COMPANY'S PROCEDURES AND THE APPLICABLE BUILDING CODE. CONTRACTOR SHALL NOTIFY THE OWNER OF ACKNOWLEDGEMENT FROM UTILITY COMPANIES THAT UTILITY COMPANY'S SERVICES HAVE BEEN CAPPED AND DISCONNECTED.
- COMPLY WITH ANSI A10.6 "SAFETY CONDITIONS FOR DEMOLITION" PUBLISHED BY THE AMERICAN NATIONAL INSTITUTE.
- CONDUCT DEMOLITION TO MINIMIZE INTERFERENCE WITH SURROUNDING AREAS.
- PROVIDE, ERECT, AND MAINTAIN TEMPORARY BARRIERS AND SECURITY DEVICES AS REQUIRED BY CODE, WHEN LOCATED IN PUBLIC RIGHT OF WAY. (CONTRACTOR SHALL PAY AND OBTAIN PERMIT.)
- PROVIDE REQUIRED FENCE SURROUNDING PROJECT SITE AT ALL PHASES/STAGES OF THE CONSTRUCTION.
- CONDUCT OPERATIONS WITH MINIMUM INTERFERENCE TO PUBLIC OR PRIVATE THOROUGHFARES. MAINTAIN PROTECTED INGRESS AND EGRESS AT ALL TIMES. DO NOT CLOSE OR OBSTRUCT ROADWAYS OR SIDEWALKS WITHOUT PERMITS.
- CONDITIONS AT THE JOB SITE SHALL BE VERIFIED BY THE CONTRACTOR. IT IS THE RESPONSIBILITY OF THE CONTRACTOR TO EXAMINE THE EXISTING BUILDINGS AND ALL THE CONDITIONS PRIOR TO SUBMITTING BIDS TO THE OWNER.
- CONTRACTOR TO IDENTIFY THE LOCATION OF DISCONNECTED OR CAPPED UNDERGROUND UTILITIES, STRUCTURES, AND IMPROVEMENTS, INCLUDING SIZE, COORDINATES OR LOCATION, AND THE ELEVATIONS. CONTRACTOR TO SUBMIT RECORD DRAWINGS TO THE OWNER.
- CONTRACTOR TO CEASE OPERATIONS AND NOTIFY THE OWNER IMMEDIATELY IF SURROUNDING STRUCTURES APPEAR TO BE ENDANGERED. DO NOT RESUME OPERATIONS UNTIL CORRECTIVE MEASURES HAVE BEEN TAKEN.
- IF CONTAMINATED OR VERMIN INFECTED MATERIALS ARE ENCOUNTERED, CONTACT THE OWNER IMMEDIATELY AND WAIT FOR DIRECTION. DO NOT DISPOSE OF HAZARDOUS MATERIALS WITHOUT FURTHER DIRECTIONS FROM THE OWNER.
- ELECTRIC OR GAS LINE CUTTING SHALL NOT BE DONE ON SITE WITHOUT A WRITTEN PERMIT.
- EXCEPT WHERE NOTED OTHERWISE IN THE CONTRACT DOCUMENTS, IMMEDIATELY REMOVE DEMOLISHED MATERIAL FROM SITE IN A LEGAL MANNER.
- DEMOLITION IS LIMITED TO DEMOLITION LIMIT LINES, UNLESS NOTED OTHERWISE.
- CONTRACTOR SHALL PAY AND OBTAIN ALL REQUIRED PERMITS REQUIRED BY PRIVATE, LOCAL, AND STATE JURISDICTIONS TO CARRY OUT ALL ITEMS IDENTIFIED UNDER DEMOLITION PLANS AND REPORTS. LETTERS AND MEMOS REFERRED TO ON THE PLANS AND IN THE SPECIFICATIONS.
- EROSION CONTROL MEASURES SHALL BE IMPLEMENTED TO PREVENT DEBRIS AND UNSUITABLE MATERIALS FROM ENTERING STORM DRAIN, SANITARY SEWERS AND STREETS.
- DUST CONTROL SHALL BE IMPLEMENTED DURING DEMOLITION.

SITE DEMOLITION NOTES:

- CONTRACTOR SHALL REFER TO THE GENERAL DEMOLITION NOTES HEREON.
- IT IS THE OWNER'S GENERAL INTENT TO CLEAR THE SITE AND, UNLESS OTHERWISE INDICATED ON THE PLANS, THE CONTRACTOR SHALL DEMOLISH AND REMOVE FROM THE SITE ALL EXISTING BUILDINGS, STRUCTURES, UTILITIES, TREES, SHRUBS, WALKS, ROADWAYS, PAVING, CURBS, GUTTERS, SIGNS, SIGN FOUNDATIONS, LIGHT POLES, LIGHT POLE FOUNDATIONS, WALLS AND THEIR FOUNDATIONS, BOLLARDS, FENCING, STAIRS AND THEIR FOUNDATIONS, AND ALL OTHER IMPROVEMENTS WITHIN THE DEMOLITION LIMIT LINE AND CAPPED AT THE DEMOLITION LIMIT LINE UNLESS OTHERWISE INDICATED ON THE PROJECT PLANS OR ELSEWHERE IN THE CONTRACT DOCUMENTS.
- THE CONTRACTOR SHALL VERIFY THE LOCATION AND QUALITY OF EXISTING SURFACE STRUCTURES AND SHALL BE SOLELY RESPONSIBLE FOR ANY UNIDENTIFIED UTILITIES, IMPROVEMENTS, TREES, ETC. TO BE DEMOLISHED AND REMOVED WITHIN THE DEMOLITION LIMIT LINE, INCLUDING APPURTENANT FOUNDATIONS OR SUPPORTS.
- UNDERGROUND STRUCTURES, UTILITIES, AND IMPROVEMENTS ARE SHOWN FROM A COMPILATION OF RECORD INFORMATION BY OTHERS. THE ENGINEER MAKES NO REPRESENTATION EXPRESSED OR IMPLIED, AS TO THE ACCURACY OF LOCATION OR THE COMPLETENESS OF SAID RECORD INFORMATION. THE CONTRACTOR SHALL VERIFY AND LOCATE ALL EXISTING ABOVE AND UNDERGROUND UTILITIES. LOCATIONS SHOWN ON THE PLANS ARE APPROXIMATE AND ARE SHOWN FOR GENERAL INFORMATION ONLY.
- CONTACT AND COORDINATE WITH THE GAS COMPANY FOR DEMOLITION AND REMOVAL OF EXISTING GAS LINES WITHIN EXISTING PUBLIC RIGHT-OF-WAY.
- THE CONTRACTOR SHALL DEMOLISH AND REMOVE ALL LANDSCAPING WATERING SYSTEMS WITHIN THE DEMOLITION LIMIT LINE UNLESS DESIGNATED TO REMAIN IN PLACE ON THE PLANS.
- THE CONTRACTOR SHALL REMOVE TREE ROOTS PURSUANT TO SECTION 300-1.1 OF THE STANDARD SPECIFICATIONS FOR PUBLIC WORK CONSTRUCTION.
- THE CONTRACTOR SHALL TRENCH AND REMOVE ALL EXISTING UNDERGROUND STRUCTURES, UTILITIES, OR IMPROVEMENTS SO DESIGNATED FOR REMOVAL ON THE PROJECT PLANS AND BACKFILL TO THE EXISTING GRADE OR FUTURE GRADE AS SHOWN ON THE ACCOMPANYING PLANS.
- THE CONTRACTOR SHALL BACKFILL SOIL IN THE EXCAVATED TREE ROOT PITS AND THE TRENCHES FOR REMOVED EXISTING UNDERGROUND STRUCTURES, UTILITIES, AND PROJECT PLANS UNLESS DIRECTED TO BY THE OWNER.
- CONTRACTOR TO SAWCUT ALL EXISTING A.C. AND CONCRETE PAVEMENT AT DEMOLITION LIMIT LINE. CONTRACTOR SHALL REMOVE SIDEWALK TO THE NEAREST JOINT.
- CONTRACTOR SHALL REPLACE ALL EXISTING IMPROVEMENTS OUTSIDE THE DEMOLITION LIMIT LINE THAT ARE DAMAGED DURING CONSTRUCTION TO MATCH EXISTING, INCLUDING PERMANENT TRENCH RESURFACING.

Area (10 x 10 feet in size) to be excavated to a depth of 1.5 feet and disposed of off-site. Centered on sample locations B53 and B55

DEMOLITION NOTES:

- THE ITEMS LISTED BELOW ARE NOT INTENDED TO BE A COMPLETE LIST OF ITEMS TO BE DEMOLISHED AND REMOVED FROM SITE. SEE ALSO SITE DEMOLITION NOTES FOR ADDITIONAL INFORMATION.
- PROTECT IN PLACE EXISTING RETAINING WALL, SEE GRADING PLAN FOR ANY SEGMENT REMOVAL.
 - REMOVE EXISTING STAGE AREA.
 - PROTECT IN PLACE EXISTING PLANTER AREA.
 - REMOVE EXISTING LANDSCAPING AND IRRIGATION.
 - REMOVE EXISTING CONCRETE LANDING, STEPS AND HANDRAILS.
 - REMOVE EXISTING CEMENT CONCRETE PAVEMENT AND BASE.
 - REMOVE BUILDING STRUCTURE COMPLETE, INCLUDING CONCRETE SLAB, FOUNDATION AND UNDERGROUND UTILITIES.
 - REMOVE EXISTING WALK.
 - REMOVE EXISTING RAMP AND HAND RAILS.
 - REMOVE EXISTING CHAINLINK GATES.
 - REMOVE EXISTING CONCRETE CURB.
 - REMOVE EXISTING CONCRETE DRIVEWAY.
 - EXISTING LANDSCAPING AND IRRIGATION TO REMAIN.
 - EXISTING PARKING AREA TO REMAIN.
 - REMOVE EXISTING ASPHALT PAVING AND BASE.
 - REMOVE EXISTING CATCH BASIN.
 - REMOVE EXISTING CONCRETE PAD.
 - REMOVE EXISTING 2" AND 3" PIPES.
 - REMOVE EXISTING SEWER CLEANOUT.
 - REMOVE EXISTING BLOCK WALL ALONG PLANTER AREA.
 - REMOVE EXISTING TREE PROTECT IN PLACE.
 - EXISTING TREE PROTECT IN PLACE.
 - PROTECT IN PLACE CONCRETE WALK.
 - EXISTING 8" SANITARY SEWER PROTECT IN PLACE.
 - EXISTING 15", 18", 39" STORM DRAIN PROTECT IN PLACE.
 - EXISTING DOMESTIC WATER LINE PROTECT IN PLACE.
 - REMOVE EXISTING YARD BOX.
 - REMOVE EXISTING TREE 18" Ø.
 - PROTECT IN PLACE ELECTRICAL INSTALLATIONS.
 - PROTECT IN PLACE EXISTING FIRE HYDRANT.
 - REMOVE PORTABLE BUILDING.
 - RAMP PREVIOUSLY REMOVED BY OTHERS.

LEGENDS:

DEMOLITION LIMITS
UTILITY DEMOLITION
SEE UTILITY PLAN FOR NEW POINTS OF CONNECTION AND UTILITY ROUTING.